

Squirrel Monkey

Squirrel monkeys inhabit parts of Central and South America, and are the smallest monkeys in the Cebidae family. Squirrel monkeys have small bodies measuring up to 30 cm, and they live in groups in forest areas, feeding mainly on fruits, berries and insects. They are very bright and inquisitive creatures and get along well with humans, giving them a reputation as the easiest monkey to keep as a pet. This paper craft model is based on the common squirrel monkey, the most well-known of all squirrel monkey types.



● Front



● Side



● Back



*Assembly instructions on pages 1 and 2, and pattern on page 3.

★ Assembly Instructions

- 1) Carefully cut out the parts.
- 2) Fold along the dotted lines, making mountain or valley folds as indicated.
- 3) Follow the order indicated in the instructional diagrams, and attach the parts to assemble.
(Read the Explanation of Symbols for more information.)
- 4) Your paper craft model is finished!

★ Tools

Scissors, glue (We recommend craft glue.)

★ Caution

Keep scissors and glue away from small children.
Be careful not to cut your fingers when using scissors.
Fold the folding lines before gluing.

★ Explanation of Symbols



Cut line



Mountain fold

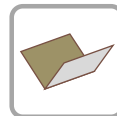

Valley fold

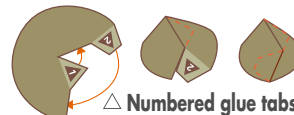
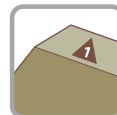

△ **Numbered glue tabs**

Glue the parts together in the order indicated by the numbers.



△ **Glue tabs with symbols and part names**

These tabs are to be glued onto the matching parts, which name is indicated on the tab.

★ Assembling the Squirrel Monkey

1 Assemble the tail

Tail

2 Assemble the body 2

Body 2

3 Assemble the body 1

Body 1

4 Assemble the head

Head

5 Assemble the snout

Snout

7 Attach the head, snout and ears

Right ear
Left ear
Head
Snout

6 Assemble the ears

Right ear

Assemble the left ear in the same way.

8 Assemble the whole body

Attach all the parts together in order as shown by ①~③.

Head
Body 2
Body 1
Tail
Complete!

